

# INSTALLATION SHEET

## RUGGED LINER

### 2021 FORD F150 UNDER RAIL BEDLINER & TAILGATE COVER

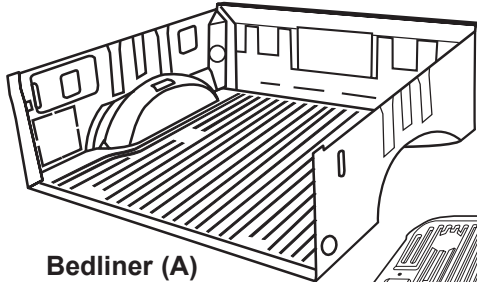

Bedliner (A)

#### LIST OF CONTENTS:

- (A) 1 - Bedliner
- (B) 1 - Tailgate Cover

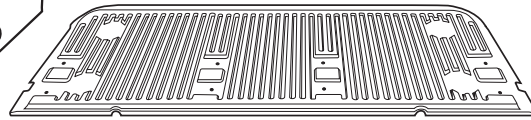

Tailgate Cover (B)

#### LIK75 KIT:

- (C) 8 - Spacers

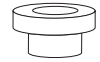

- (D) 3 - 4" Round Hole Cover



- (E) 2 - Push Pins

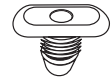

#### MISSING PARTS???

Call Rugged Liner at

**800-433-3604**

Any required parts will be shipped to you directly.  
(DO NOT return whole kit to store)

#### TOOLS REQUIRED:

- Screwdriver with T20 Torx bit in steps 3-5.
- Utility knife in step 7.

#### CARE and MAINTENANCE RECOMMENDATIONS:

To protect the finish of this product, clean with soap and water, do not use abrasive substances.

**1**

**PLEASE READ INSTRUCTIONS CAREFULLY BEFORE STARTING THE INSTALLATION.**  
One person can perform the installation but we recommend a two-person installation.



**2**

#### VEHICLE PREPARATION:

It is important that all areas of the cargo box of your truck are clean and free of debris prior to installing.



**3**

Remove the (8) factory screws from the metal access plate attached to the tailgate using the screwdriver with Torx (T20) bit. **(Save the screws).**

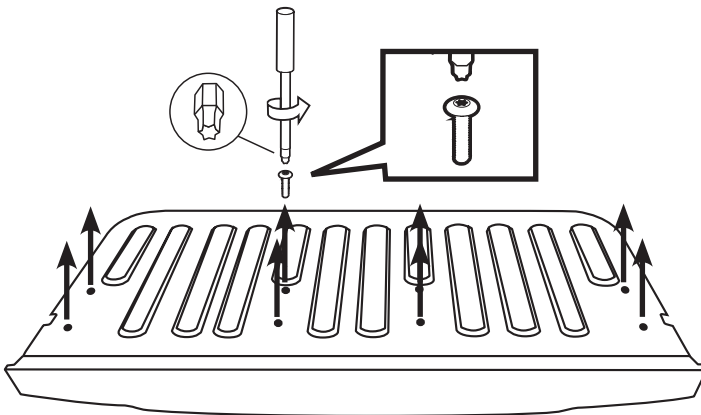

**4**

Install the tailgate cover (B), by centering the pre-drilled holes onto the metal tailgate. Place one of the spacers (C) provided in each of the (8) holes. Then replace the screws that you saved in step 3.

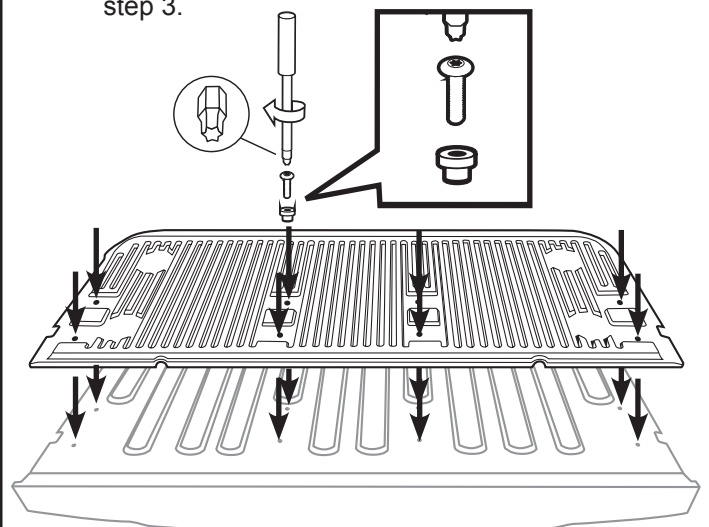

# INSTALLATION SHEET

## RUGGED LINER

## 2021 FORD F150

- 5** Remove driver side rear cleat fasteners using the screwdriver with Torx (T20) bit. (Save cleat and fasteners).

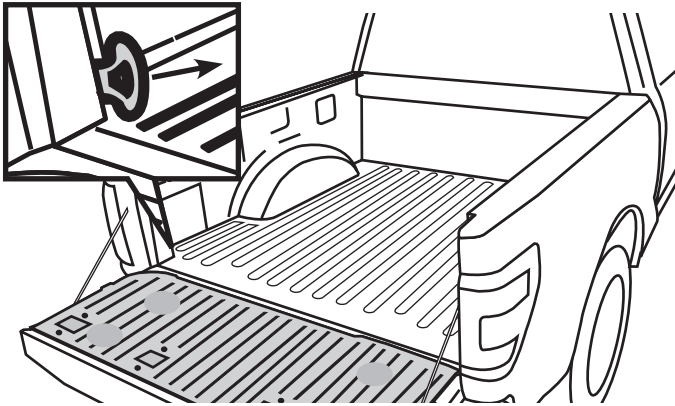

- 6** If your truck comes with the optional power panel (1) or tie-downs (2,3,4,5). See step 7.

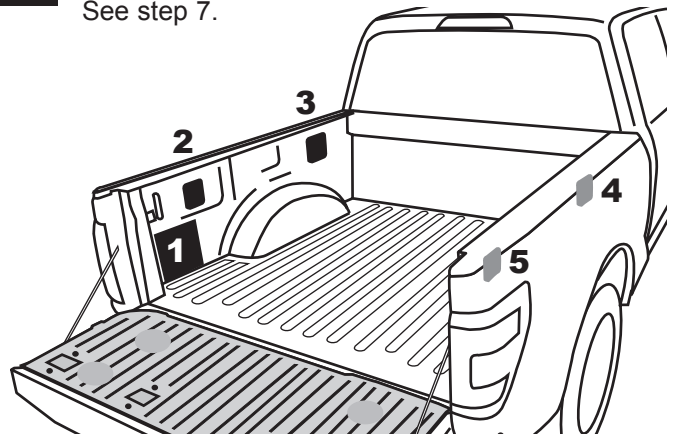

- 7** Before installing the bedliner; open the power panel (1) and/or tie-downs (2,3,4,5) by cutting out the tabs in the bedliner that hold the partially cut areas.

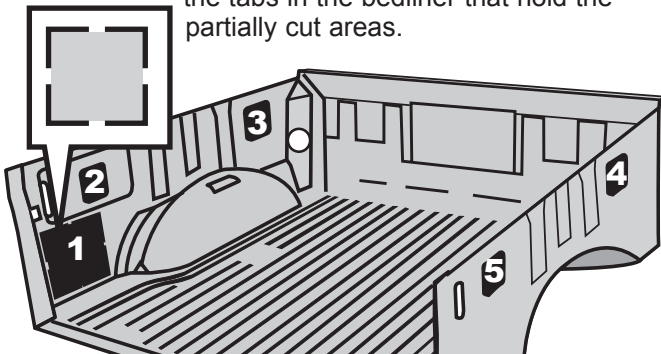

- 8** Drop the bedliner (A) straight down, then push the side walls under the truck side rails. Make sure the center locking column on each side are fully engaged under the rail lip.

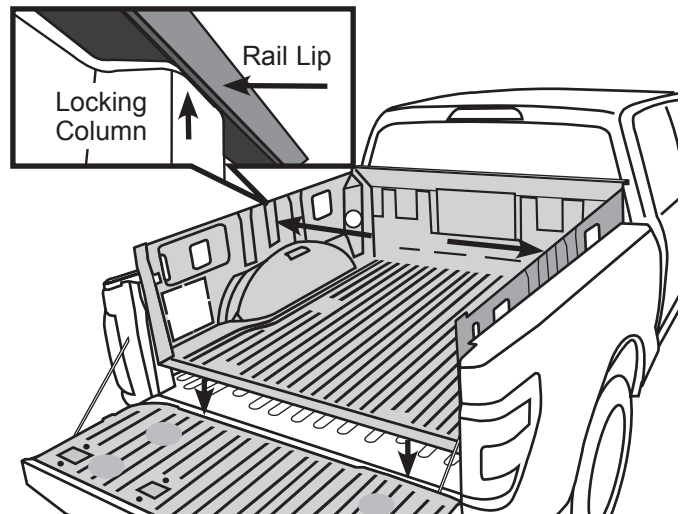

- 9** Locate the pre-drilled holes on the area behind the D-pillar and install one push pin (E) on each side. Locate the pre-drilled holes on the bottom area behind the D-pillar of the driver side and re-install the cleat with the screws saved in step 5.

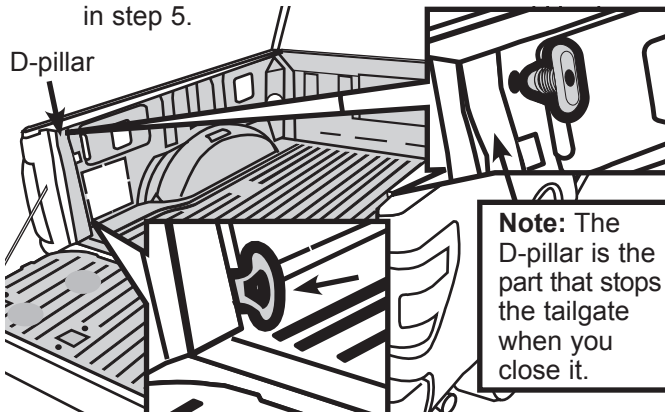

- 10** Install the round hole covers (D) provided in the 3 tie-down access holes.

