

INSTALLATION SHEET

RUGGED LINER

REAR INNER WHEEL WELL LINERS 09-18 RAM 1500 & 19 CLASSIC

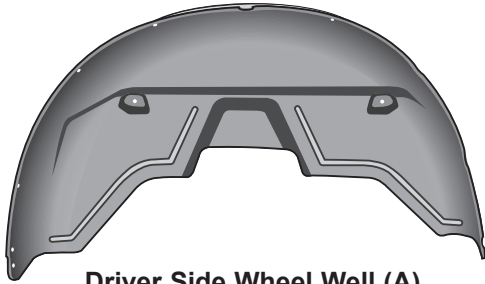

Driver Side Wheel Well (A)

LIST OF CONTENTS:

- (A) 1 - Driver Side Wheel Well
- (B) 1 - Passenger Side Wheel Well

LIK62 KIT:

- (C) 20 - Push Lock Pins

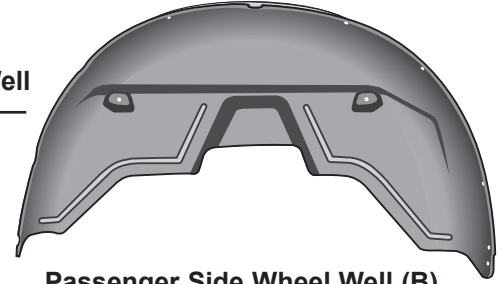

Passenger Side Wheel Well (B)

MISSING PARTS???

Call Rugged Liner at

800-433-3604

Any required parts will be shipped to you directly.
(DO NOT return whole kit to store)

TOOLS REQUIRED:

- Ratchet with 8mm socket in step 3, 4 & 9.

1

**PLEASE READ INSTRUCTIONS CAREFULLY
BEFORE STARTING THE INSTALLATION.**
One person can perform the installation.



2

VEHICLE PREPARATION:

It is important that all areas where the wheel wells mount are clean and free of debris prior to installing.



3

For Trucks with Mud Flaps:

Remove mud flaps before installing wheel well liners.
Then follow steps 4-10.
Re-install mud flaps.

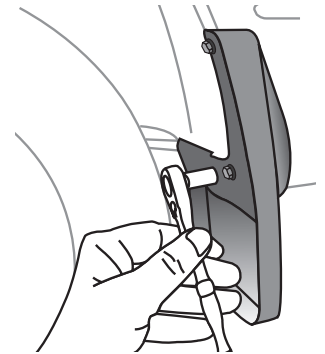

4

Note: If your truck model came **without** the optional wheel well liners and fasteners please skip to step 5.

Note: If your truck model came **with** the optional wheel well liners, remove all (11) factory fasteners using a 8mm socket/driver holding the factory liner in place.
(Keep all factory fasteners).

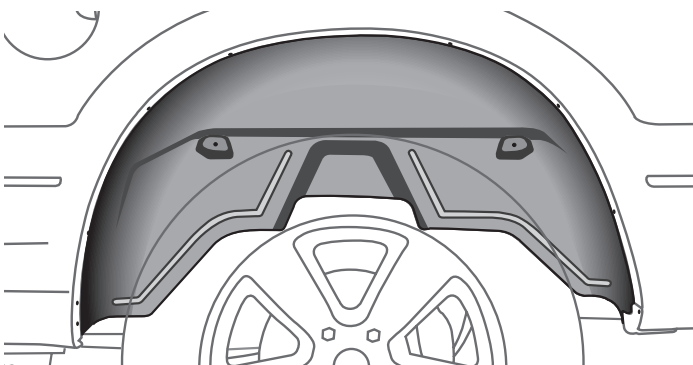

5

Start on the driver side by setting the driver side wheel well (A) marked as (DS) inside the inner panel of the truck's wheel well behind the tire.

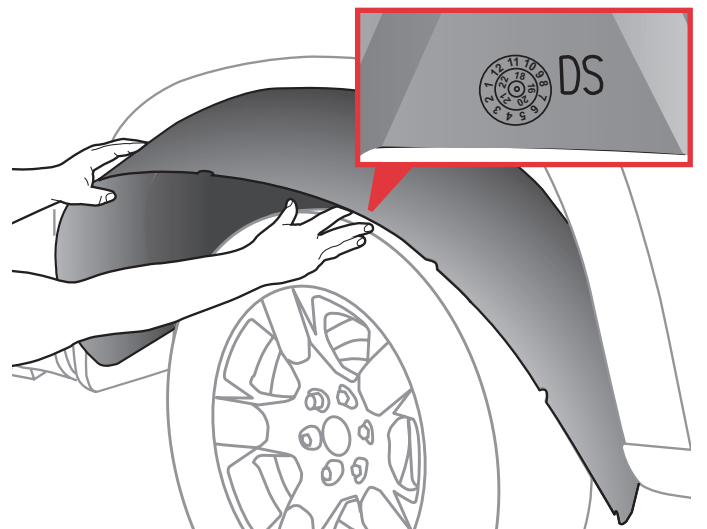

INSTALLATION SHEET

RUGGED LINER

09-18 RAM 1500 & 19 CLASSIC

- 6** Tuck the lower cab part of the wheel well liner behind the metal lip of truck's fender.

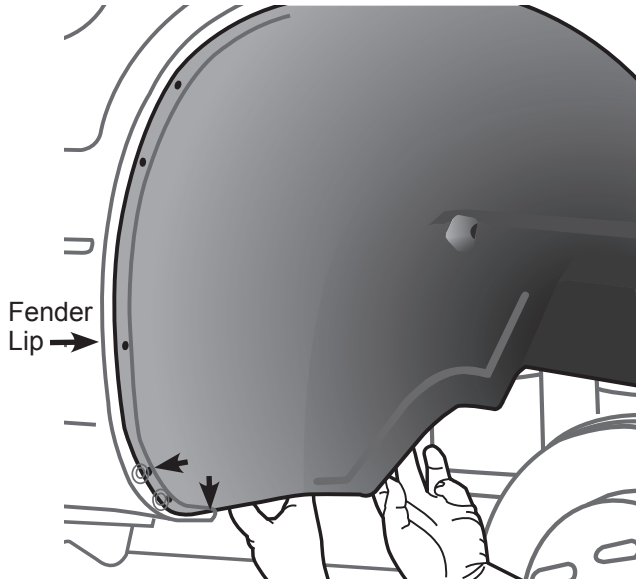

- 7** Tuck the lower tail part of the wheel well liner behind the metal lip of truck's fender. Also tuck it behind the factory rock guard.

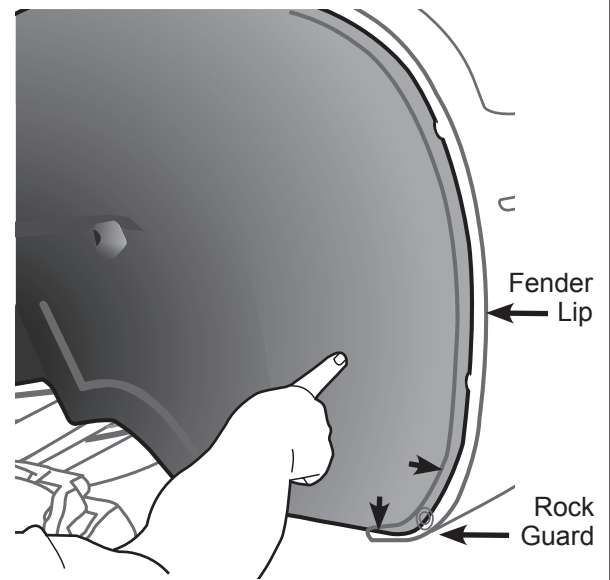

- 8** Tuck the upper part of the wheel well liner behind the rest of the metal lip of the truck's fender.

- 9** Locate all (8) pre-drilled holes and (2) half moon cutouts in the wheel well liner and align them with the holes in the truck's wheel well. Then insert the (10) push lock pins (C) provided in the kit. **Note:** Trucks that came with OEM factory liners, use the fasteners for positions 1,2,3,8,9,10.

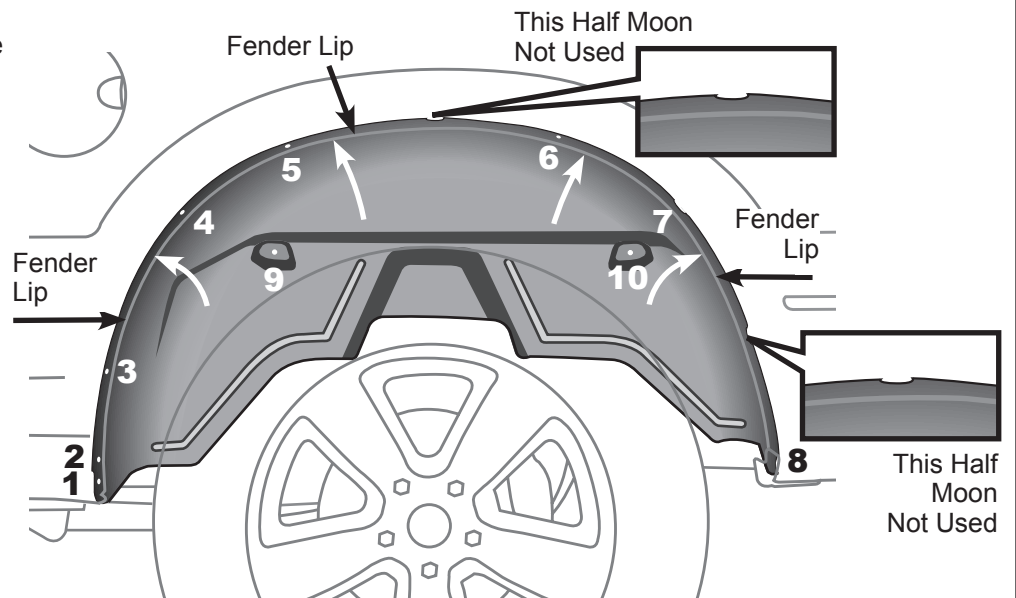

- 10** Repeat steps 3-9 on the passenger side when installing the passenger side wheel well (B).

